

Kyoto University Research Reactor Institute (KURRI)

From Kumatori Station

The closest station to KURRI is JR Kumatori Station.

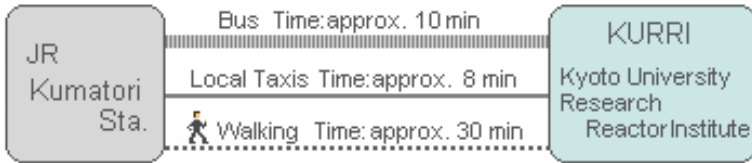

▶ Bus

JR Kumatori Sta. (Nankai Bus) → Genshiryoku Kenkyusyo Mae (Nankai Bus for Osaka Taikudaigaku Mae)
Cost : 170yen

▶ Local Taxis

Taxi ranks are located at JR Kumatori Station.
Cost : approx. 900yen

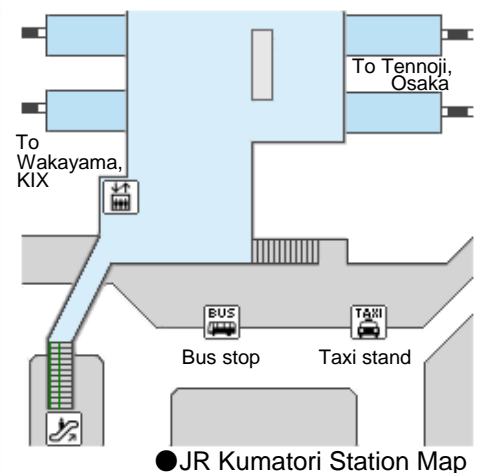
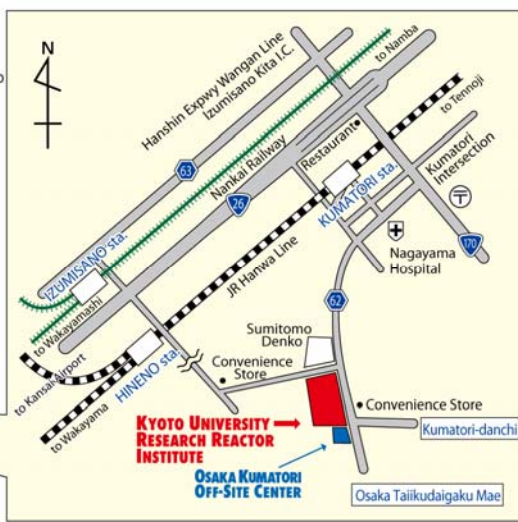

To Kumatori Station

Traveling times do not include the time needed for transferring.

▶ From Kyoto University

Cost : approx. 1100yen

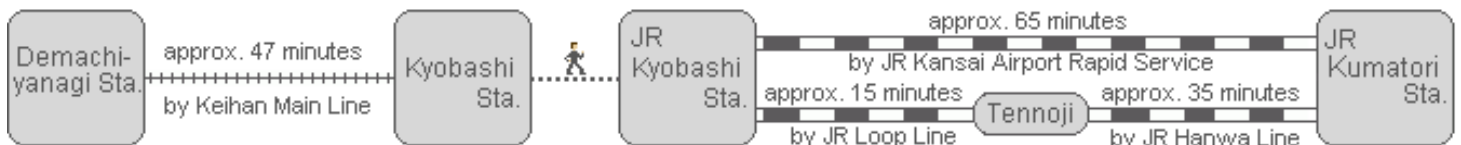

▶ From Shin-Osaka Station

Cost : 800yen

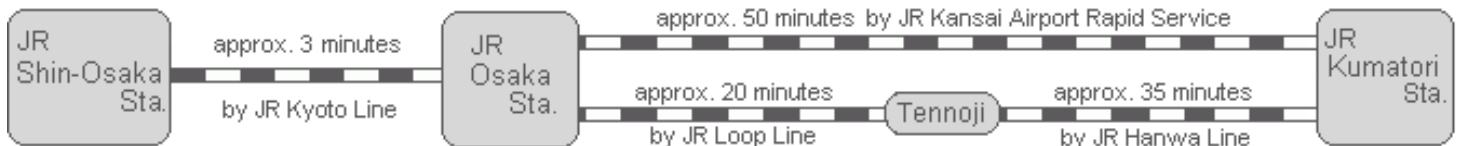

▶ From Kansai International Airport (KIX)

Cost : 460yen



▶ From Osaka International (Itami) Airport (ITM)

Cost : approx. 1200yen

